

Tefal[®]

EXCEL AQUA PLUS

EN
HK

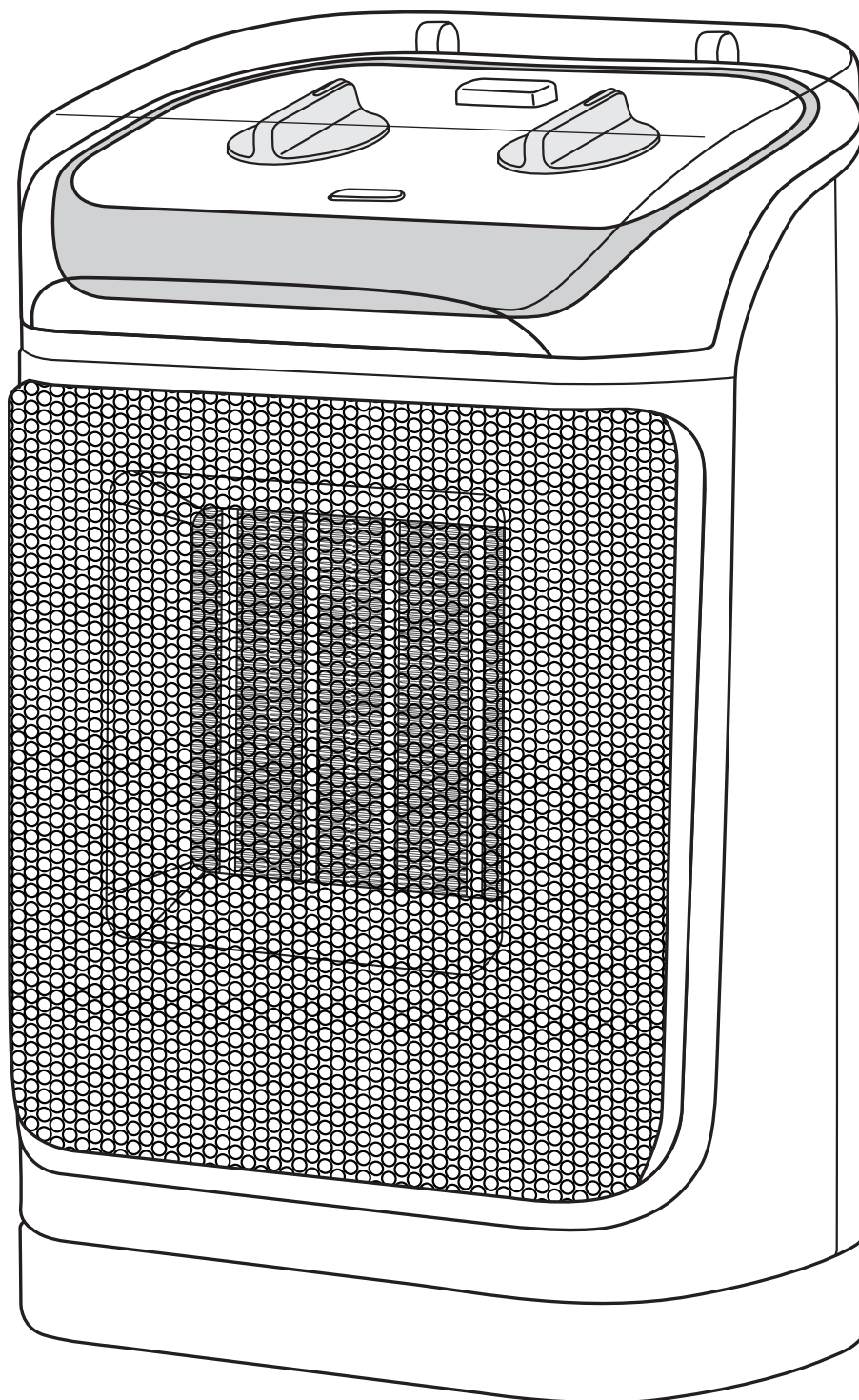

SE9285

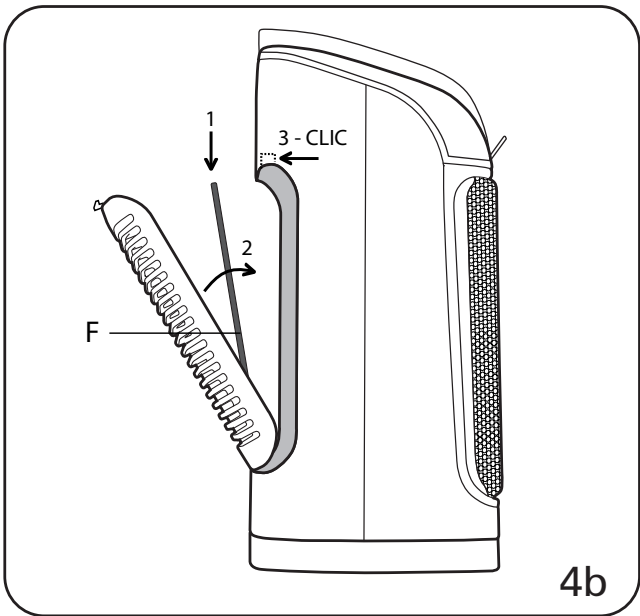
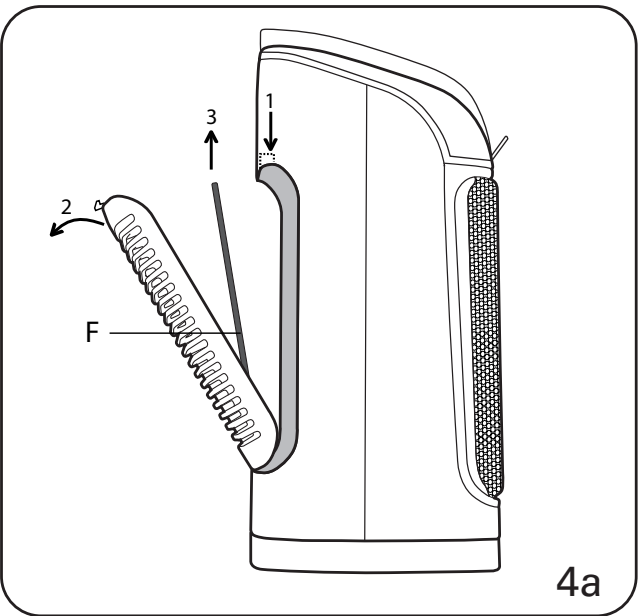
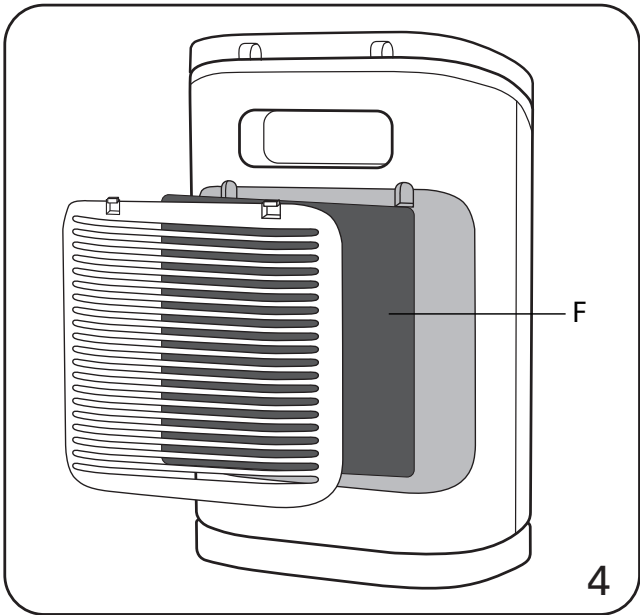
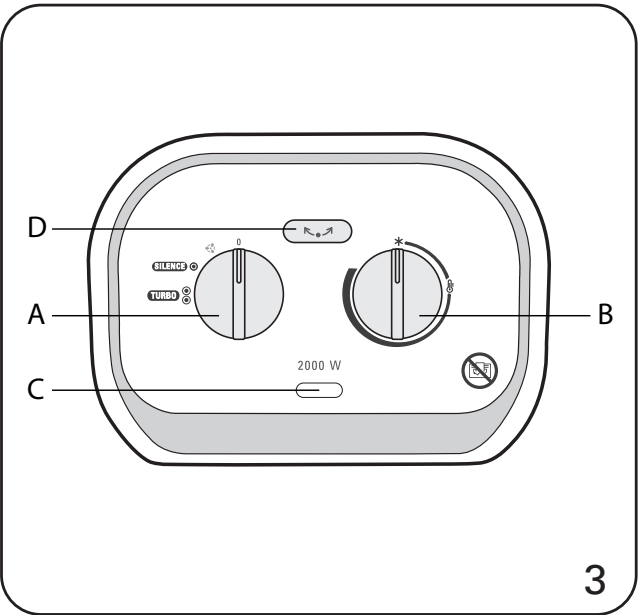
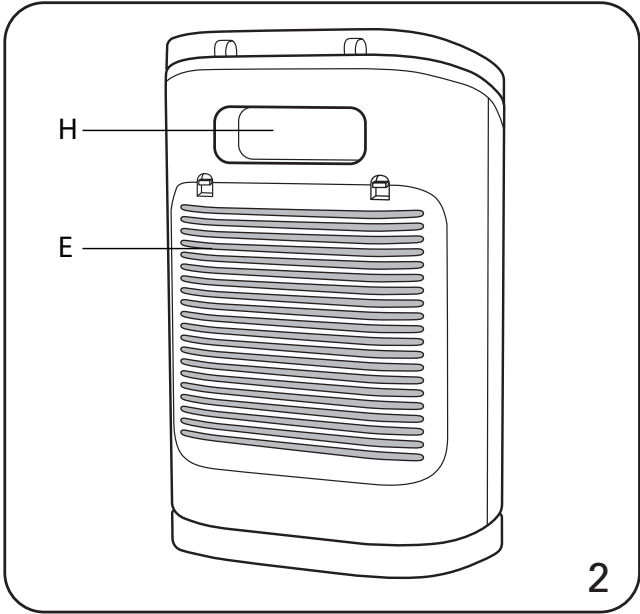
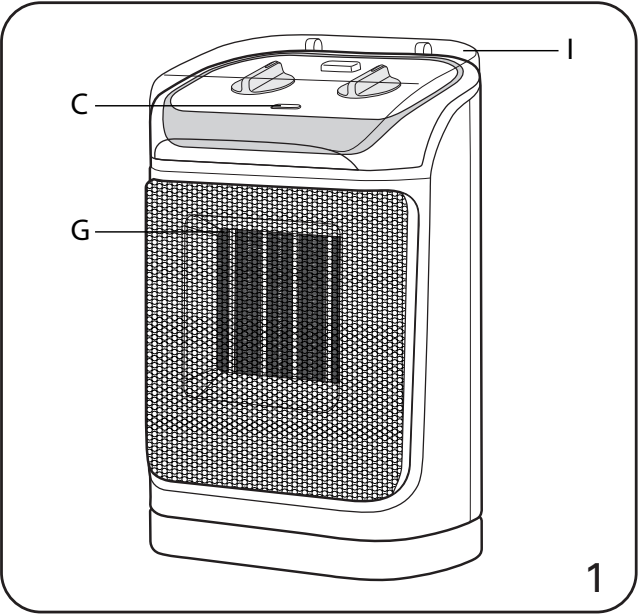



- A. Function selection switch
- B. Temperature control switch: Thermostat
- C. On/Off indicator
- D. Oscillation control
- E. Air intake grille
- F. Removable, washable filter protecting the air inlet grille
- G. Air outlet grille
- H. Carry handle
- I. Protective splash cover



- A. 功能選擇按鈕
- B. 溫度調節按鈕：恆溫器
- C. 接通電源指示燈
- D. 搖擺功能
- E. 進氣口
- F. 可拆式，可清洗過濾網，能保護進氣口
- G. 出氣口
- H. 手柄
- I. 面蓋防止水濺

1 - WARNINGS

- For your safety, this appliance complies with the applicable standards and regulations or commercial (Low Voltage, Electromagnetic Compatibility, Environmental Directives, etc.)
- The warranty will be invalid in the event of damage arising from incorrect use.
- Do not place your appliance immediately below a socket outlet.
- Do not operate your appliance in a dusty room or if there is a risk of fire.
- Each time before use, check that in general the appliance is in good condition, as well as the plug and the cord.
- Never insert any objects inside the appliance (e.g.: needles)
- If the power cord is damaged, it must be changed by the manufacturer, the After Sales Service or a similarly qualified person in order to avoid any danger.
- This appliance is not intended for use by persons (including children) with reduced physical, sensory or mental capabilities, or lack of experience and knowledge, unless they have been given supervision or instruction concerning use of the appliance by a person responsible for their safety. Children should be supervised to ensure that they do not play with the appliance.
- Do not pull the power cord or the appliance, even to unplug it from the wall socket.
- Completely unwind the cord each time before use.
- This product has been designed for domestic use only. Any commercial use, inappropriate use or failure to comply with the instructions, the manufacturer accepts no responsibility and the guarantee will not apply.

2 - VERY IMPORTANT

• **WARNING : IN ORDER TO AVOID OVERHEATING DO NOT COVER THE HEATER**



- Do not touch the appliance with wet hands.
- Do not let water get into the appliance.
- Do not use this appliance near baths, showers, sinks or swimming pools.
- Do not use the appliance near inflammable objects and products (curtains, aerosols, solvents, etc.).
- Do not use the appliance when tilted or laid flat.
- DO NOT FORCE THE OSCILLATION BY HAND.
- In the event of prolonged absences: stop the appliance using button A position " ○ " and unplug it.
- Never use the appliance without its filter.
- However, the electrical installation in the room, the installation of the unit and the way the unit is used must all comply with the safety standards in force in your country.

3 - USE IN THE BATHROOM (protection against splashing with water)

- This "IP21" unit has been specially designed so that it can be used in any room in your house, including those where there is a risk of water being splashed onto it from above (kitchen, bathroom, etc.).

4 - VOLTAGE

- Before first use, make sure that the voltage being used corresponds to what is indicated on the unit and that the electrical installation is adapted to the power level indicated.
- Your appliance can be used with a power plug without an earth connection. It is a class II appliance (double insulation).

5 - SAFETY

- In the event of abnormal overheating, a safety device shuts down the appliance and then automatically restarts it once it has cooled. If the fault persists or gets worse, a thermal fuse shuts the appliance down completely and it must then be taken to an approved service centre.

6 - OPERATION

Before turning the unit on, make sure:

- it is positioned as described in these instructions,
- that it is placed on a flat and horizontal surface, and;
- that the air intake and outlet grilles are free of all obstacles.

• Function Selection :

Select the desired function by turning switch A (3) to line up the marking on the switch with one of the following symbols:

- : off
- : 1000W
- ❄ : cooling
- ⦿ : 2000W

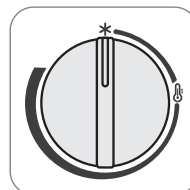

• Indicator:

- On/Off indicator C (3), lights up when the unit is turned on.

• Thermostat:

Adjust the temperature setting, according to your own comfort, by turning button B (3).

• Frost-free setting * :

This setting enables you to automatically maintain the temperature above 0°C in a normally insulated room, whose volume corresponds to the power of your appliance.

Plug in the unit and turn switch B (3) to line up the marking on the switch with the " * " symbol and turn switch A (3) to select one of the following:

- 1000W or ● 2000W.

• Cold ventilation setting ❄ :

This setting enables you to use your fan heater as a cooling fan in summer.

• Rotation :

The rotation button D (fig. 3) allows you to rotate your appliance in order to optimise the diffusion of hot air in the room.

7 - CLEANING

- Your appliance must be unplugged before proceeding with any cleaning work.
- You can clean it with a slightly damp cloth.
- IMPORTANT: Never use abrasive products which might damage the appearance of your appliance.
- Your appliance is fitted with a removable and washable dust filter (soap and warm water), which has to be cleaned regularly (Fig. 4a and 4b).
- Always ensure that the filter is thoroughly dry before replacing it.
- Never use the appliance without its filter.

8 - STORAGE

- It is extremely important that the unit be allowed to cool down before it is put away.
- When you are not using your appliance, store it in a dry place.

9 - IN THE EVENT OF PROBLEMS

- Never dismantle your appliance yourself. A poorly repaired appliance may be dangerous for the user.
- Before contacting one of our Approved Service Centres, ensure that:
 - the appliance is set to normal operating mode;
 - the air inlet and outlet grilles are totally clear.



10 - ENVIRONNEMENT PROTECTION FIRST!

Your appliance contains valuable materials which can be recovered or recycled. Leave it at a collection point.



請在使用暖風機前認真地細閱說明書，並將說明書保存妥當。

1. 注意事項

- 請仔細閱讀說明書，並遵守以下使用規則：
- 為確保您的安全，該暖風機符合現行的標準和法規 (包括低壓指令、電磁兼容、環境保護等標準)
 - 維修保養服務並不包括因使用不當而導致的損壞
 - 請勿將暖風機置於影響電源插座的地方
 - 有存在火災危險或有很多塵埃的地方，請勿使用該暖風機
 - 每次使用前，請事先檢查暖風機機身，插頭和電線是否狀態良好
 - 請勿將任何異物放入該暖風機內 (如: 針等物體)
 - 如果電線出現破壞，應當由製造商，售後服務部門或其他專業人員來更換，以避免發生事故
 - 身體、感官或智力有障礙的成人(包括兒童)，或對該暖風機無任何操作經驗的人，請勿使用該暖風機：除非有專業人仕在場負責照顧他們的安全，並事先給他們解釋該暖風機的操作規則。同時請監督兒童，不要讓他們隨意擺弄暖風機
 - 請勿拉拖暖風機或電線。切斷電源時，不要將電線從牆壁插座上拉扯下來
 - 每次使用時，請將電線完全展開
 - 該暖風機設計只為家居使用。任何商業用途、或未有依照指示使用而導致的損壞，製造商並不負責，維修保養亦不包括在內

2. 重要注意事項

- 注意: 為避免過熱的危險，請勿將物件遮掩著暖風機
- 在接觸該暖風機前，請保持雙手乾爽
- 切勿讓水或液體流入暖風機內
- 切勿在浴缸、洗手盆或游泳池旁使用暖風機
- 切勿在易燃物件或產品附近使用暖風機 (如: 窗簾布、煙霧劑、熔劑等)
- 切勿將暖風機斜放或臥放使用
- 切勿用手強力搖擺暖風機
- 如果長時間停用該暖風機，請將按鈕A轉到 ○ 位置，並且拔掉電線
- 切勿在未裝上過濾網時使用暖風機
- 使用及安裝該暖風機的零件或電線均須符合國家規定



3. 浴室內使用 (防止濺濕)

- 該暖風機備有IP21設計，可在家中任何房間使用

4. 電壓

- 在首次使用前，請檢查電壓與該暖風機上標示的電源相符
- 這是II級標準的電器，因此該暖風機使用時可不必地線接觸(即是雙重絕緣電器 □)

5. 安全

- 當暖風機不正常地發熱，內置安全裝置會馬上把電器關閉；並等待電器降溫後再自動重新啟動。如果此不正常發熱的現象持續或變差時，內置熱熔保險絲會完全關閉電器；請立即將該暖風機送到維修中心檢查

6. 操作

- 在開始使用前，請確保：
 - 該暖風機的位置符合本說明書的規定
 - 該暖風機放於水平且穩定位置
 - 該暖風機之進出氣口沒有被堵塞

- 功能選擇：
 - 請使用按鈕A(3)，選擇你所需要的功能，將按鈕的標誌調較到相應的符號：

- : 停止 • : 1000瓦
- ❄ : 冷風 • : 2000瓦

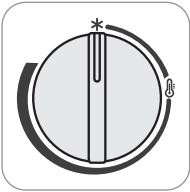

- 指示燈：
 - 接通電源指示燈C(3)。當暖風機開啟後，指示燈亮起

- 恆溫器：
 - 根據個人舒適程度，可使用按鈕B(3)調節溫度

- 防霜功能 *：
 - 此功能可令一間較保暖的房間保持於 0度 以上溫度。防霜範圍視乎暖風機功率之大小而定。
 - 接通電源後，請轉動按鈕B(3) 以使按鈕標誌正對著符號 “*”，隨後轉動按鈕A(3)來選擇下述功能：● 1000瓦 或 ● 2000 瓦

- 冷風功能 ❄：
 - 在盛夏時，選擇此功能可作風扇使用

- 搖擺功能 ◀▶：
 - 搖擺功能按鈕 D (圖3) 可令暖風機轉動，有效加速暖氣在房間內擴散

7. 清理保養

- 在清潔暖風機前，必須先拔去電源插頭
- 使用微濕的布擦淨暖風機
- 注意: 切勿使用含磨蝕的清潔產品，否則會損壞暖風機的表面
- 該暖風機配有可拆除及可清洗的防塵過濾網 (可用肥皂及溫水清洗)，必須定期進行清洗 (請參閱圖4a 及4b)
- 更換過濾網前，請必須確保過濾網完全乾透
- 緊記勿在未有裝上過濾網前使用暖風機

8. 儲存

- 緊記要等到暖風機完全冷卻後才可收起
- 不使用時，可將暖風機存放在陰涼地方

9. 遇到故障

- 切勿自行拆除暖風機。不合規格的修理會對使用者造成危險。
- 與售後服務部門聯絡前，請事先檢查：
 - 暖風機已經調較至正常模式
 - 進出氣口沒有異物堵塞



10. 環境保護

- 該暖風機含可循環再造的物料。請棄置於收集箱。



